

User Guide

Wallbox



Wallbox Overview

Accessories of Mode C

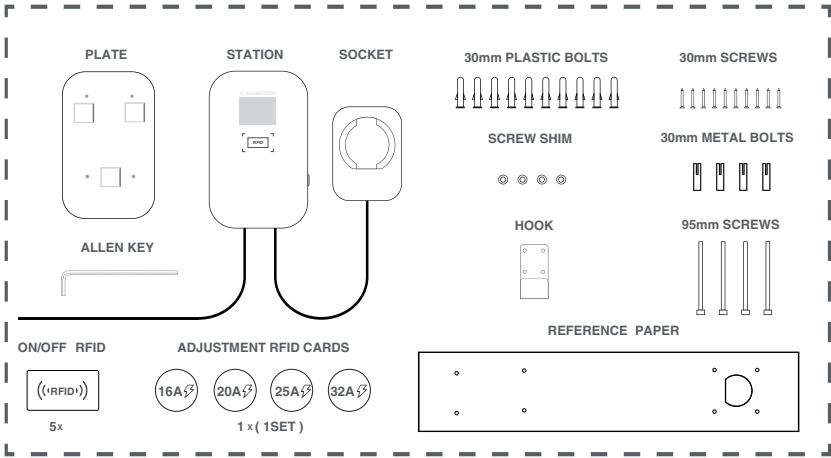

Mode C Station Overview

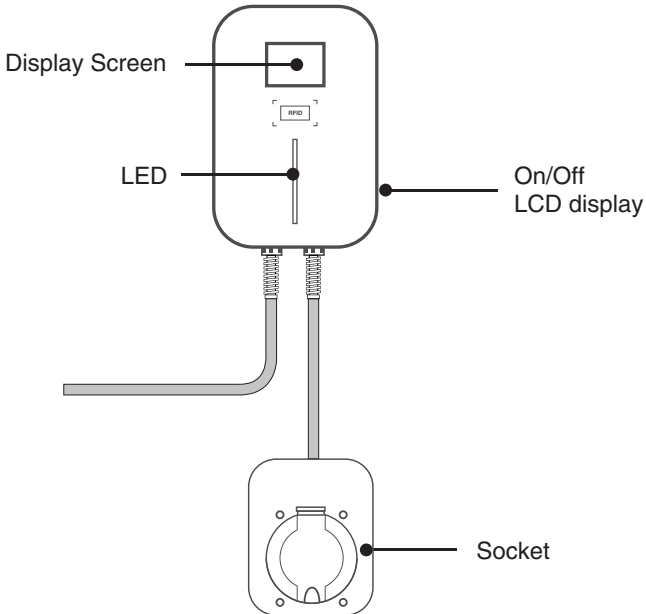

Level 2 EV Charging Station

Installation Method: Wall/Stand

Certificate: TUV,CE

Start Mode: RFID

IP Rating: IP66

Phase: Single / Three

Rated Current: 16A,20A,25A,32A

Maximum Power: 22kw

Operating Temperature: -40℃ ~ 55℃

Enclosure Material: ABS+PC alloy

Rated Voltage: 230VAC / 400VAC (±10%)

Security Protection:

Warning and display functions

Open circuit protection

Output overcurrent protection

Input under voltage protection

Over temperature protection

Residual Current Protection

Input overvoltage protection

Charge status detection

DC-RCM: Type B (30 mA AC + 6mA DC)

Instruction for Use

1

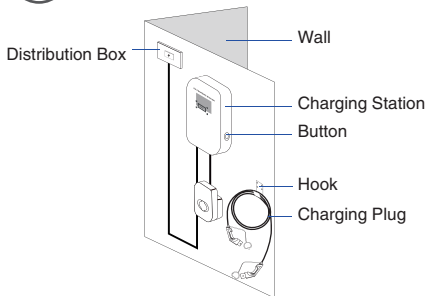

Make sure the walbox is connected to power

2

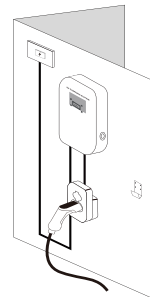

Insert the plug into socket

3

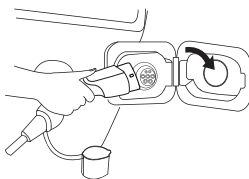

Connect the EV and the wallbox with the EV charging cable

4

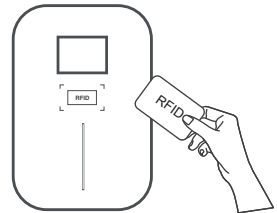

Present RFID card to initiate charging

Installation Guide

①

REFERENCE PAPER
of installing screw hole size

Wall

Drill the holes according to
the REFERENCE PAPER

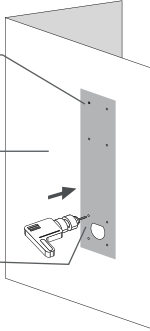

②

Hammer the
30mm PLASTIC BOLTS
into the holes

Hammer the
30mm METAL BOLTS
into the holes

Take down the
REFERENCE PAPER
from the wall later

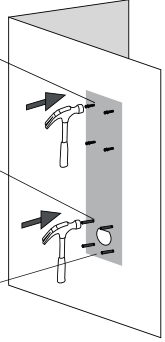

③

Fix the PLATE with
30mm SCREWS on the wall

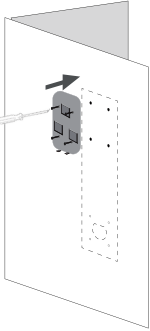

④

Embed STATION
into PLATE on the wall

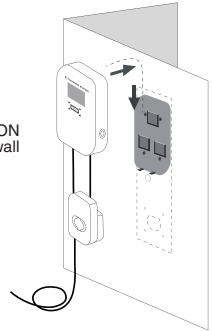

⑤

Take out the plate from
the body of charging
SOCKET

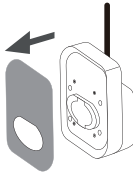

⑥

Fix the SOCKET on the wall
with 95mm SCREWS
by ALLEN KEY
and put the plate back to the
body of SOCKET

95mm SCREWS

Screw Shim

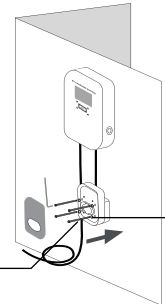

⑦

Connect the inlet cable and
the power supply correctly

This is the final completion pic,
you can put the HOOK
anywhere you need

The cable can be hung on the
HOOK

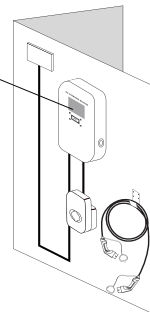

⑧

Use adjustment cards to set
correct current level based
on infrastructure capacity.

Adjustment has to be
completed within first 30
minutes after power up.

NB! Adjustment is only to be
carried out by an authorized
installer!

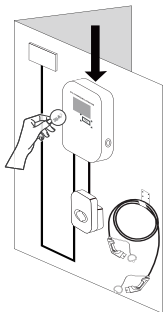
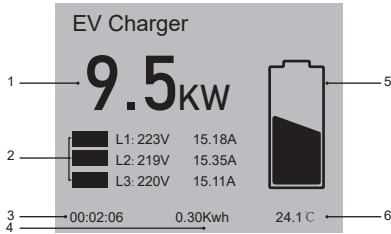
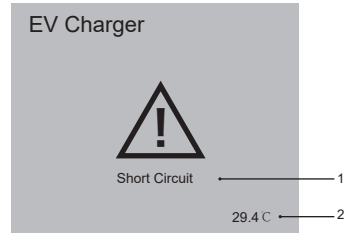

Illustration of Screen



1. Realtime effect in kW
2. Voltage and current pr phase
3. Charging session duration
4. kWh charged
5. Charging animation
6. Temperature



1. Fault message
2. Unit temperature

Note: When problems occur, the wallbox will automatically restart to try to fix the problem and continue charging.

Caution

- ◆ Failure to follow instructions may result in danger.
- ◆ The charging station shall be operated by adults only.
- ◆ Do not disassemble the charging station while it's operating.
- ◆ Install a charging station away from pyrotechnics, dusty or corrosive places.
- ◆ Only use the charging station when it's normally operating and please strictly follow the instructions.
- ◆ The charging station produces high voltage output. You must pay attention to personal safety when using it.
- ◆ If malfunction happens, it may cause electric shock or even death. Under emergency situations, you can cut off the power supply.

About Maintenance

In order to ensure the normal service life of the charging station and reduce risk, maintenance must be performed within the specified time. The maintenance of the equipment must be completed by professionals with qualified and safe maintenance tools.

The product is already packed in factory. During transportation, strong impact and bumps should be avoided to avoid damage to the outer packaging of the product.

The product should be placed at an ambient temperature of $-40\text{ }^{\circ}\text{C} \sim 55\text{ }^{\circ}\text{C}$ with a relative humidity of no more than 95%. The air should not contain acids, alkalis or other corrosive gases and explosive gases.

Security Warning

Failure to follow instructions may result in danger!

▲ Regularly check whether the charging station has visible damage. There may be a electric shock when operating the broken charging station.

▲ Make sure that all safety facilities are available at all times and are tested regularly to ensure they can operate normally.

▲ If a ground fault occurs, it must be assumed that the cable carries voltage. Please confirm that there's no high-voltage power in the system before inspecting the charging station.

▲ Persons who install and use charging stations must obey the principles and regulations mentioned to ensure the personal safety and equipment safety.

▲ Before powering on the device, please confirm that the device is properly grounded to avoid unnecessary accidents.

▲ All tools' unnecessarily exposed metal parts should be insulated to prevent them from touching the metal frame to avoid short circuit.

▲ Do not modify, retrofit, or change any part by yourself under any circumstances.

▲ To ensure the service life and stable operation of the charging station, the operating environment should be kept as clean as possible with a relatively stable temperature and humidity. The charging station must not be used in flammable environment or environments with volatile gas.

▲ Be sure to confirm that the input voltage, frequency, circuit breakers and other conditions of the device meet the specifications before the device is powered on.

Overhaul

AC charging stations are subject to stringent quality inspections. Mode 2 Charging is subject to stringent quality inspections. From the day of purchase, any problem of product quality can be reflected to the dealer within two years.

Any direct damage or malfunction caused by neglect, incorrect use, installation, usage, repair by the users or natural damage are not covered by the warranty.

Dear customer,

Thank you for choosing our EV Charging Station.

In order to enjoy a better using experience and maintenance, please read the manual and keep it carefully.

This device contains no user-serviceable parts; please do not refit anything because of the complexity of circuit board and other electronic component. Otherwise, we take no responsibility for hurt or injury caused by personal modification.

This instruction aims at guiding users to use the device correctly and does not represent any statement of configuration of the product.

For more information, please contact us.

MANUFACTURER

Nanjing LuAo international tradeCo.,Ltd.

+86-025-8662-3210

No.128,Aoti,Jianye District, Nanjing, Jiangsu, China

(Please do not contact the manufacturer's phone for after-sales questions)

